

Magic Buoy – Tritoon Parker System Manual

Table of Contents

1. Brief Overview
2. System Assembly
3. Dock Installation
4. Adjustment
5. Removal & Winterizing
6. Troubleshooting

Brief Overview

Thank you for choosing the Magic Buoy Tritoon Parker System. While the system is intuitive and easy to use, proper setup and a clear understanding of how each component functions are essential for achieving the best possible docking experience.

Please read this manual thoroughly before beginning installation or use.

System Assembly

Each system is pre-assembled at our facility to ensure proper fit. Some components may remain partially assembled for packaging.

Included Components (see drawing):

1. Buoy End Tube
2. Extension Tube
3. Dock Side Tube
4. Buoy Pull Strap
5. Buoy Mount Strap
6. Foam Fender Straps (2)
7. 20" Buoy
8. Foam Disks (12)
9. Angle Strap
10. 3/16" Allen Key
11. 5/16" Screws & Washers (16)

12. Packing Foam (used for assembly)

14. Dock Side Strap

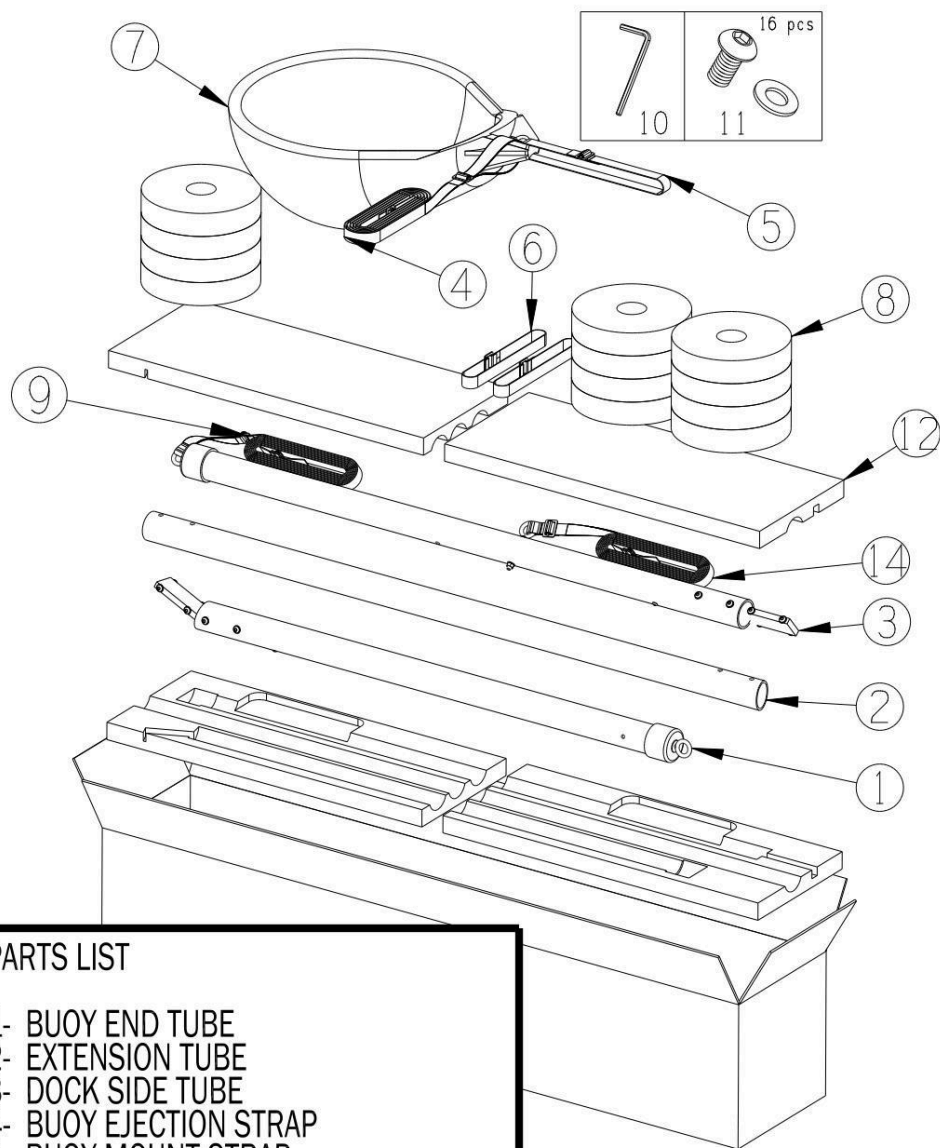

PARTS LIST

- 1- BUOY END TUBE
- 2- EXTENSION TUBE
- 3- DOCK SIDE TUBE
- 4- BUOY EJECTION STRAP
- 5- BUOY MOUNT STRAP
- 6- FOAM FENDER STRAP (2)
- 7- 20 INCH BUOY
- 8- FOAM DISKS (12)
- 9- ANGLE STRAP
- 10- 3/16 ALLEN KEY
- 11- 5/16 SCREWS AND WASHERS (16)
- 12- PACKING FOAM (USE FOR SETUP)
- 14- DOCK SIDE STRAP

⚠ Important: Assemble the main tube set on land. These components do not float.

Step 1 – Lay out tubes 1, 2, and 3 on the packing foam (see drawing). Ensure the angled ends of tubes 2 and 3 are properly aligned. Tube 3 must align with the straps as shown.

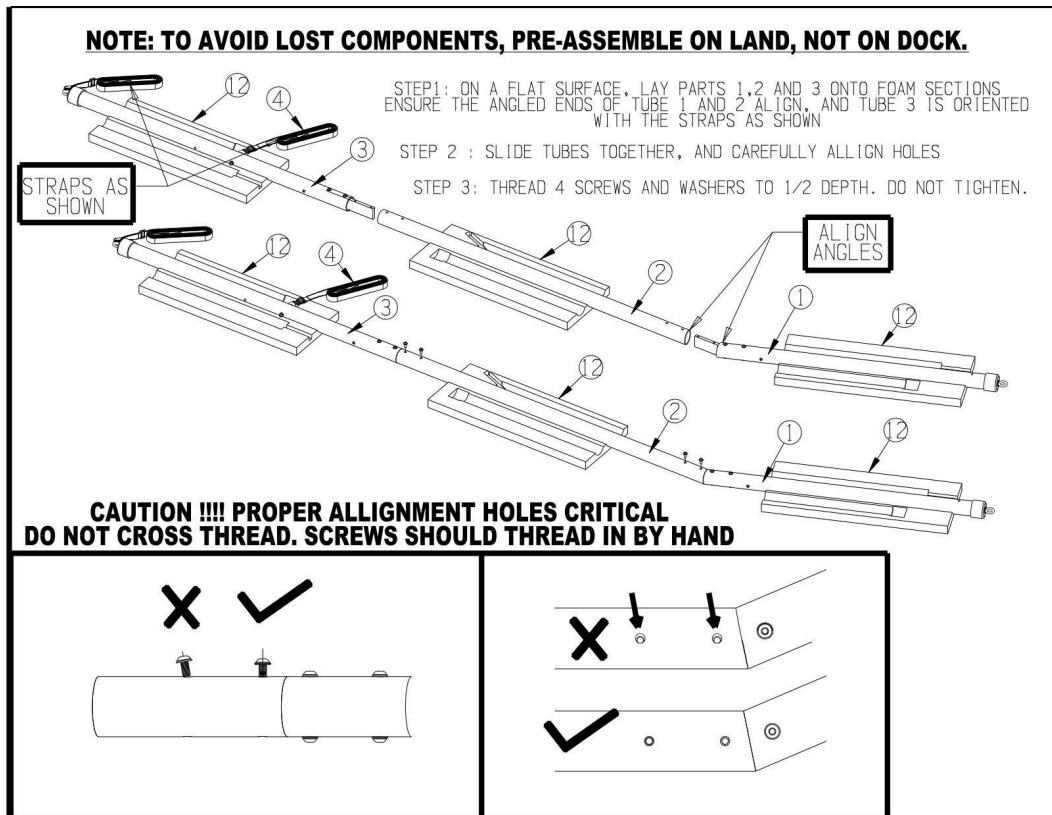

Step 2 – Slide tubes together, aligning threaded holes in the aluminum brackets with the tube screw holes. Install 4 screws by hand. Do not cross-thread. Screws should insert easily. Tighten only halfway to allow for easier alignment of screws on the opposite side.

Step 3 – Rotate the tube assembly 180°.

Step 4 – Insert 4 more screws and tighten to 12–14 ft-lbs (firm hand-tight using the Allen key).

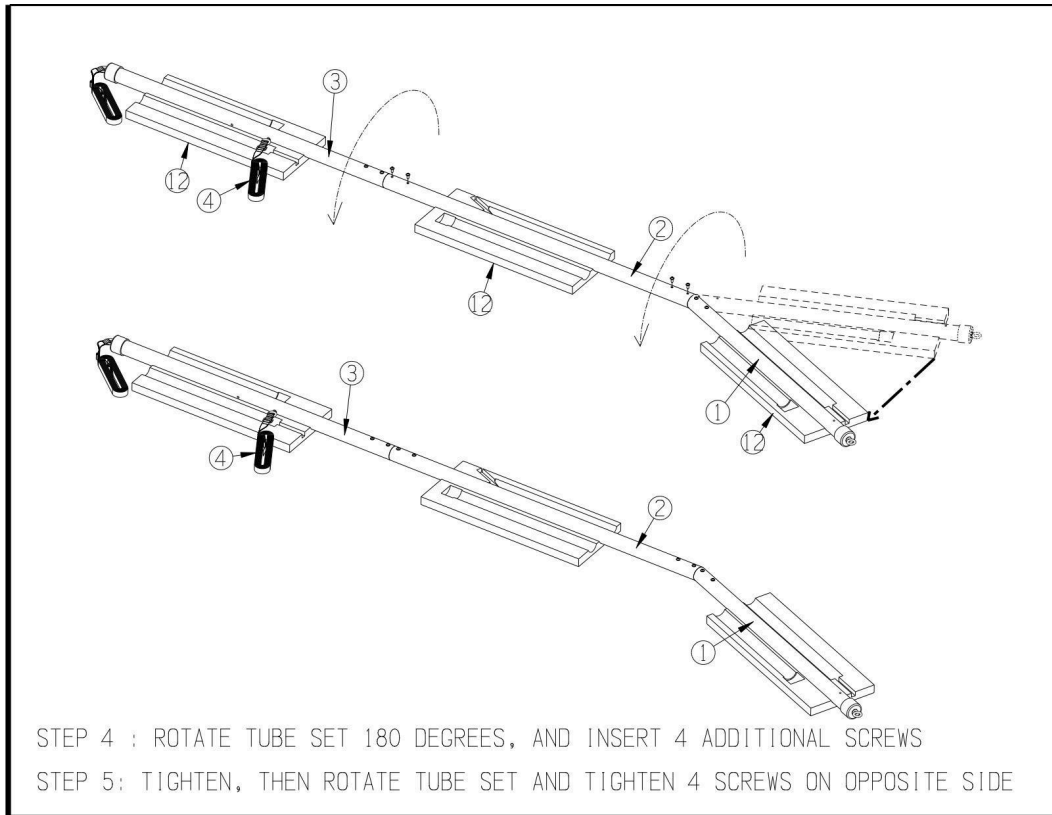

Step 5 – Rotate back 180° and finish tightening the original 4 screws.

Step 6 – Inflate the buoy according to the manufacturer’s specifications.
Do not underinflate — the buoy must resist compression between pontoons.

Step 7 – Attach the buoy strap as shown.

Step 8 – Assemble temporary fenders using packing foam (see diagram).

Step 9 – Adjust the buoy strap for water depth. Use a 20” strap length for water over 36” deep. Shorter straps reduce shock absorption and should only be used when necessary.

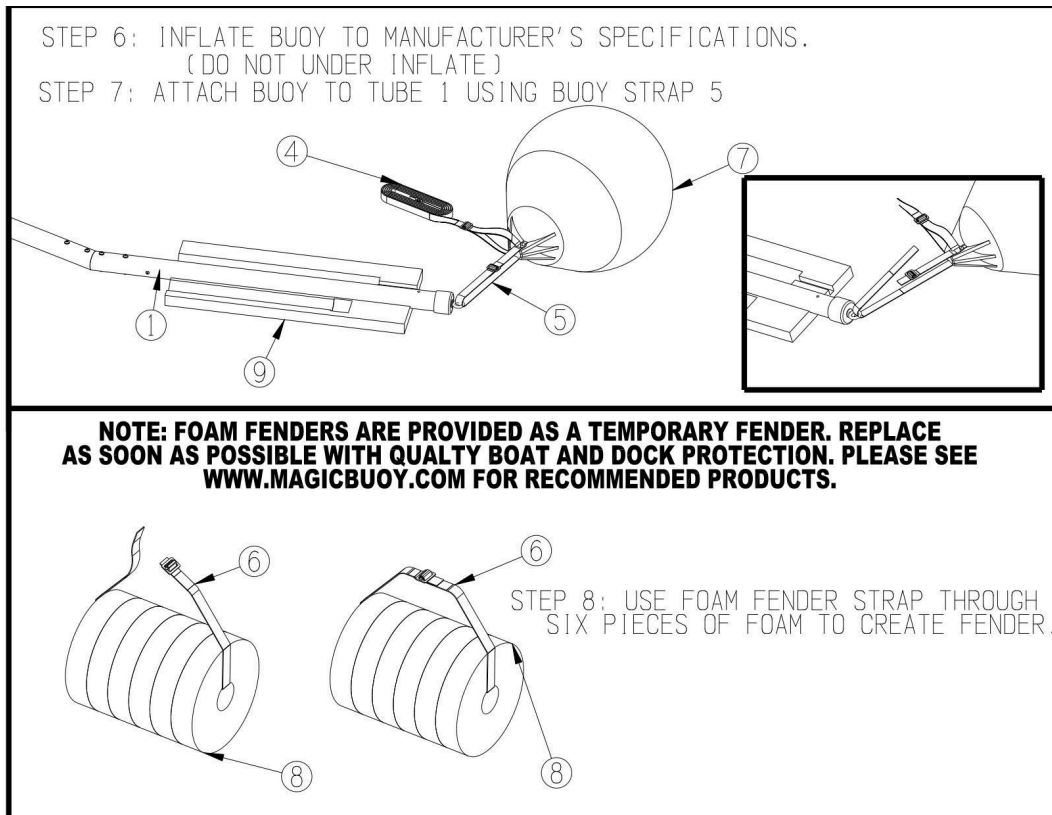

Step 9 – Adjust the buoy strap for water depth. Use a 20” strap length for water over 36” deep. Shorter straps reduce shock absorption and should only be used when necessary.

STEP 9: SET BUOY STRAP LENGTH. 20 INCHES FROM EYEBOLT TO BUOY MOUNT HOLE IS OPTIMUM. IF WATER DEPTH IS LESS THAN 36", REDUCE THE STRAP LENGTH ACCORDINGLY. NOTE: A REDUCED LENGTH WILL ALSO REDUCE THE BOAT'S STOPPING DISTANCE.

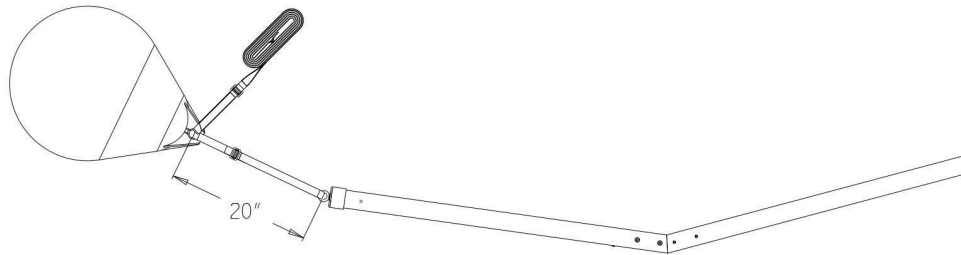

Dock Installation

Strap Configuration

Boat-Side Strap

Located ~30" from the dock-end of the tube. Secure it to the dock face where the boat will be parked.

Recommended tie-off point: 12–13 feet behind the intended boat stop position.

Angle Strap

Attached at the far (dock-side) end of the tube. Route it under the dock at a 35–45° angle, avoiding obstacles like chains or posts. This strap determines the system's resting position.

Buoy Attachment

The 20" buoy supports the far end of the tube, which remains suspended in water.

Buoy Ejection Strap

Ensures the buoy pulls clear of the pontoons when the boat reverses out.

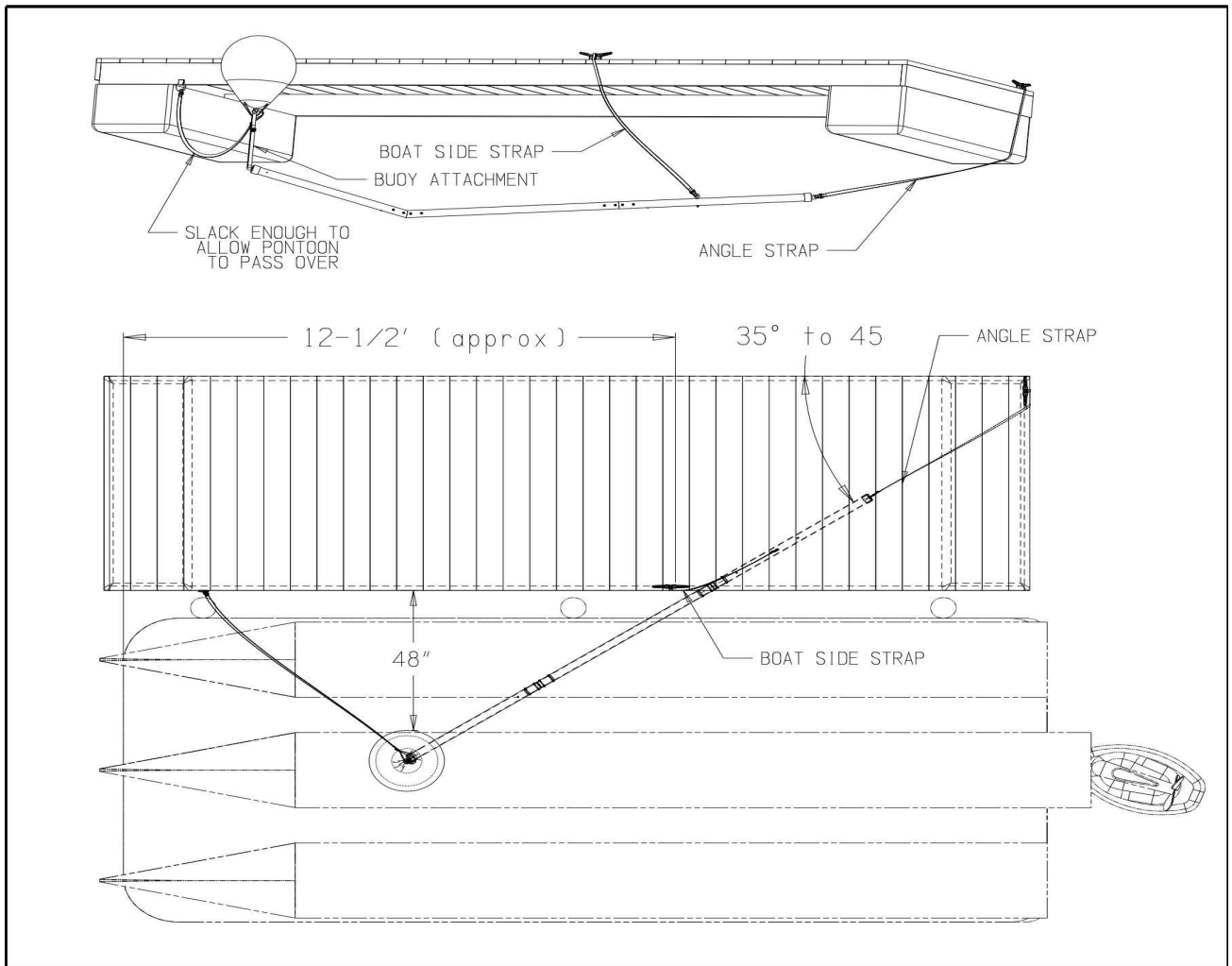

Launching the System

1. Hold both the boat-side and buoy ejection straps. Gently lower the system into the water.
2. Prevent the angle strap from falling into the water.
3. Submerge the tube until it rests 3–4 feet below the surface.
4. Tie off the boat-side strap.
5. Route the angle strap under or around the dock, avoiding obstacles, and temporarily tie it off.
6. Tie off the buoy ejection strap loosely. It should remain slack when the system is at rest.

Positioning the Buoy

While every dock and boat setup is unique, use these as baseline settings:

- Confirm boat-side strap is secure and system is submerged ~3 feet.
- Apply tension to the angle strap to pull the buoy outward from the dock.
- Aim for ~48" spacing between dock and buoy when at rest (no load).

Fine-Tuning Adjustments:

- Adjust tie-off point of the angle strap to change the buoy's resting arc (see diagram).
- Adjust slack ratio between boat-side and angle straps to shift the system along its arc.

Tie off the buoy ejection strap loosely. It assists in dislodging the buoy if it gets stuck between pontoons during docking.

Fendering (Important!)

Included are two temporary foam fenders made from packaging material. These are for initial use only and not intended for long-term protection.

If your boat lacks large-diameter fenders (10"+), we strongly recommend purchasing appropriate fenders.

Fender Placement

Position fenders especially near the bow to prevent the splash guards from hitting the dock. Adjust placement based on your boat's configuration (see diagram).

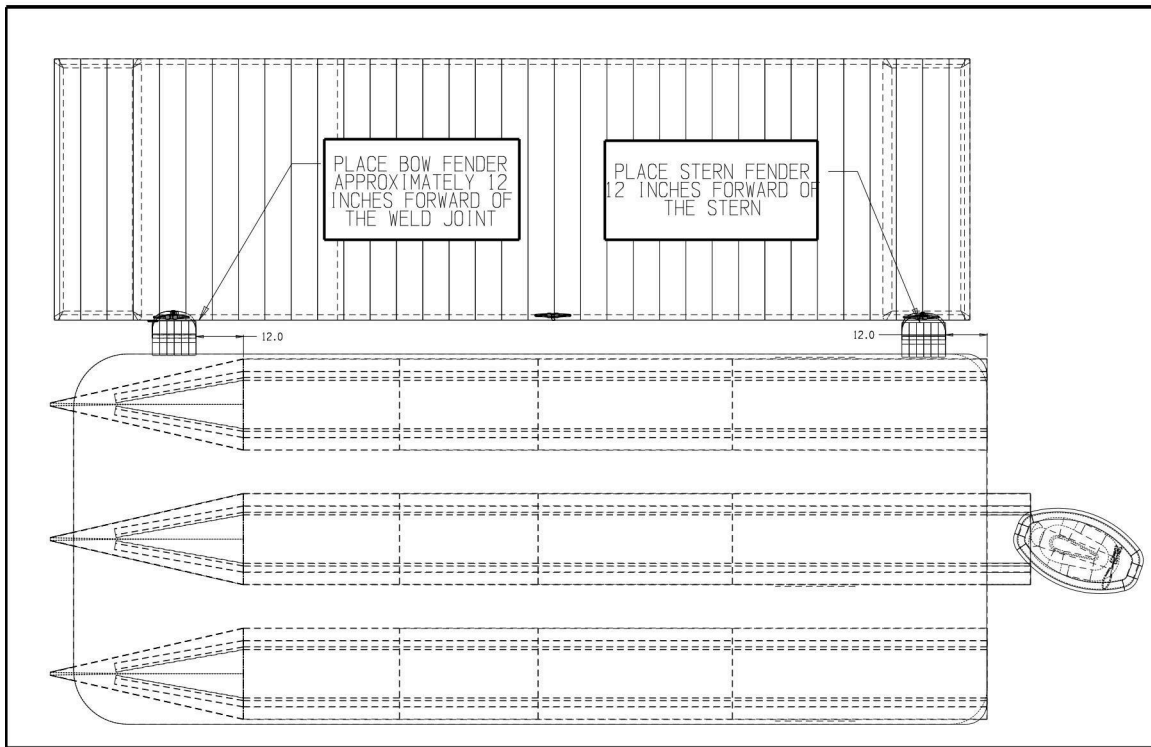

Testing & Final Adjustment

After installation:

1. Conduct test dockings with help from someone on the dock.
2. Check bow clearance and adjust fenders as needed.
3. Adjust strap tensions or tie-off points as required — this is normal.
4. Once satisfied, install permanent cleats or tie-off rings on the dock.
5. Mark line positions with tape or use slide adjusters to simplify re-installation after cleaning or winter.

Docking Procedure

 Important: All maneuvers should be performed at idle speed only. Never use throttle. Excess thrust may damage the system, boat, or dock.

1. Before approach: Note wind/current conditions. A flag on your dock can help gauge wind direction.
2. Approach slowly: Use forward-neutral-forward pulses to maintain low speed and control. Avoid reverse unless necessary.
3. Align with buoy: Steer the buoy between the dock-side and center pontoons. Open the bow gate for visibility (ensure passengers stay clear).
4. Coast in: Allow the buoy to enter between the pontoons. Just before contact, steer away from the dock.
5. Engage buoy: As contact begins, shift into forward (idle) with helm turned away from the dock. The buoy will slow the boat while thrust pushes the stern in.
6. Hold position: The boat will remain stationary in gear. Crew may disembark safely. Solo users should have a safety line ready for tying off before leaving the helm.
7. After docking: Once in neutral, the boat may drift 1–2 feet backward — this is normal and should be accounted for in final system setup.

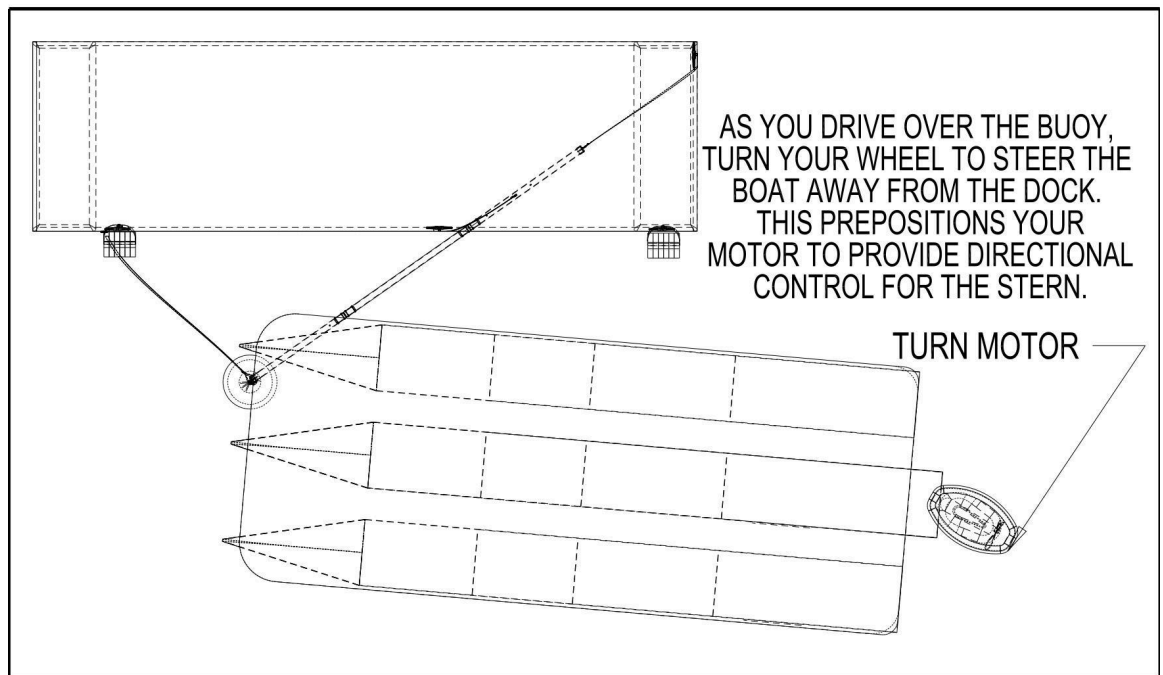
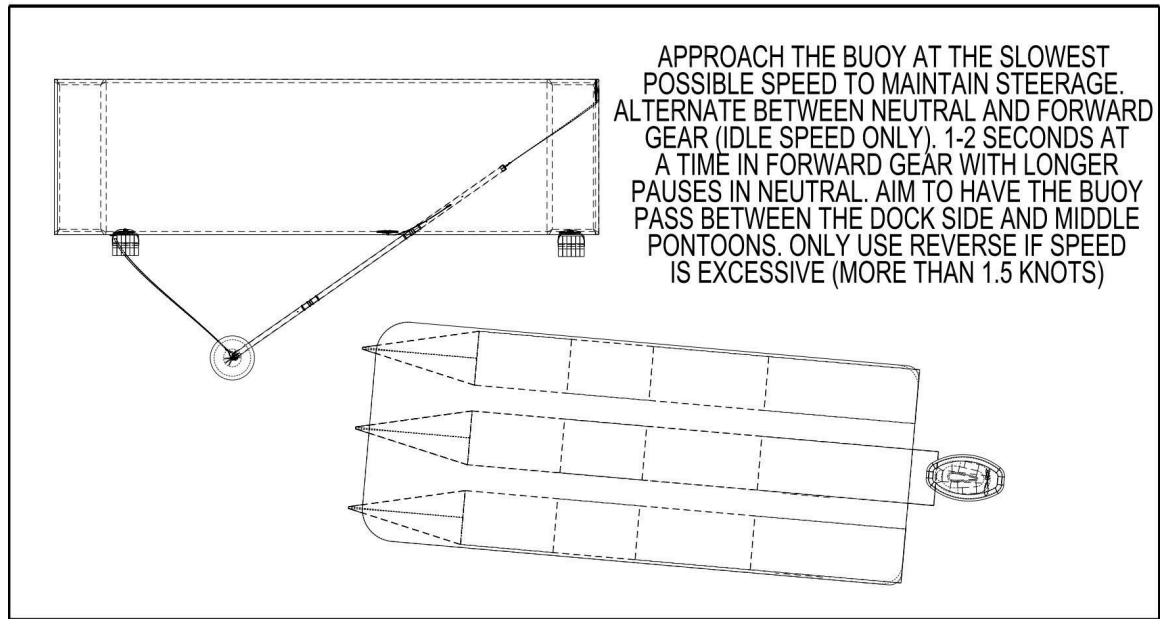

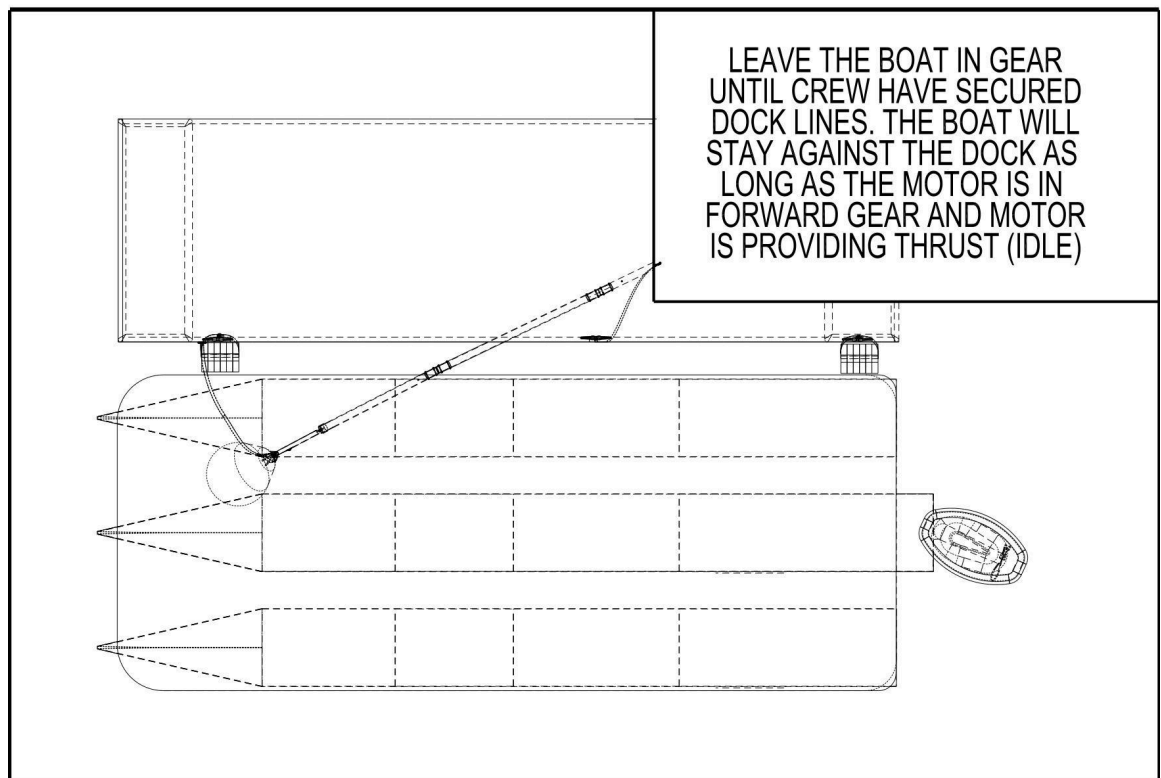
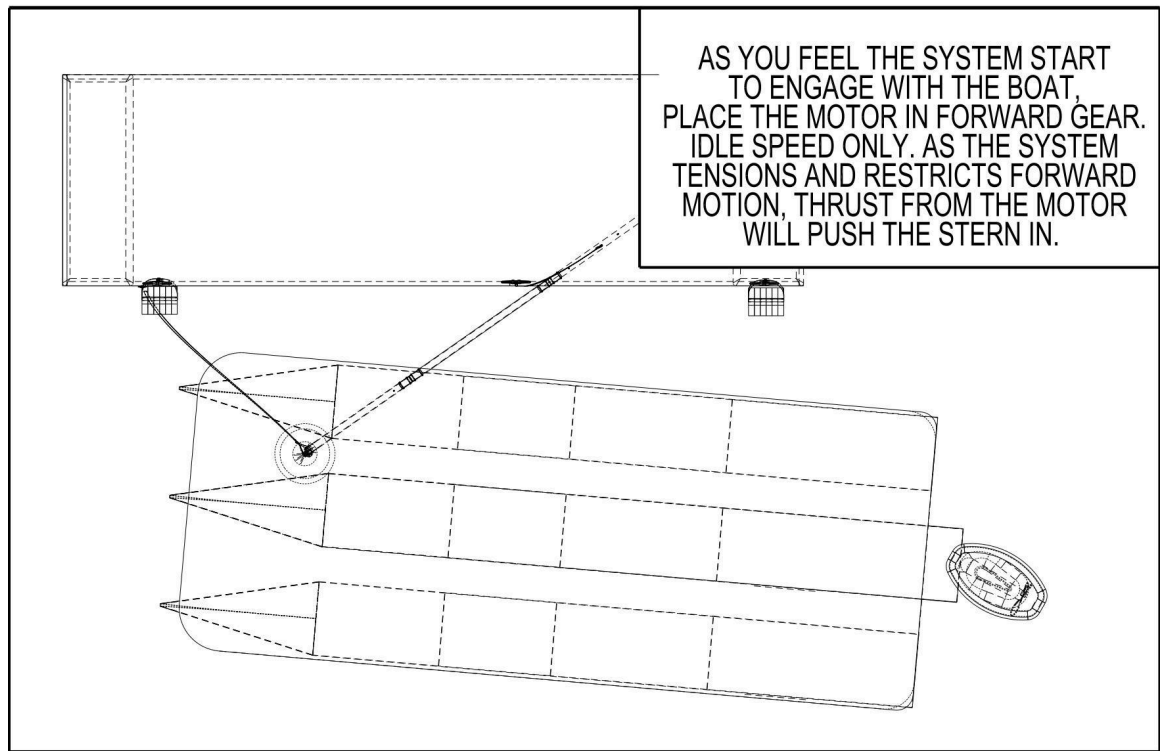

Departure Procedure

The system also supports smooth departures:

1. Before untying, engage forward (idle) with helm away from the dock.
2. The system will hold the boat in place while crew unties at leisure.
3. Once ready, steer toward the dock and remain in forward (idle).
4. The buoy will hold the bow while the stern swings outward.
5. Reverse out once the stern clears. The buoy pull strap prevents dragging the system with the boat.